



United Aluminium



//retail merchandising unit

cutting edge design

attention to detail

versatility

retail display solutions

retail merchandising unit

unibox[®]
retail display

- RMU
- Reception desks
- Kiosks
- Showcases



//retail merchandising

The Unibox range of retail display products provide high quality, cutting edge solutions for Centre owners, agents and retailers.

The versatility of the Unibox Modular System has been used to create product ranges which include: showcases, kiosks and stand-alone Retail Merchandising Units. These units have already effected an increase in commercialisation and revenues in mall areas in Centres such as Lakeside, Bullring, Metro Centre and many others throughout the UK.

retail merchandising unit

RMUs



retail display solutions

Unibox RMUs are fully factory built or delivered to site in easy to assemble modules.

units

//individually designed to meet your needs

If you want to maximise sales in public spaces, be it fashion ware, consumer electronics, jewellery, flowers, cameras or brand promotions... why not explore the possibilities with the Unibox design team.

All power and data transfer requirements can be accommodated and are designed and inspected by NICEIC approved electrical engineers. The Firetrace automatic fire detection and extinguisher system, configured and fitted by our own certified engineers, complies with legislation and protects your investment.



- Quality
- Design
- Functionality



retail merchandising unit

retail display solutions

RMUs

In today's hectic and crowded retail world, grabbing customers' attention can be extremely challenging. Glitz were looking for new and innovative ways to showcase their jewellery and attract more customers. Unibox were the natural partner to help them stand apart from the crowd.

"Put simply, the new Super RMU boosts sales. We're very happy with the results and will be using the units as a key element in our expansion programme in the UK."

Glitz

www.unibox.co.uk

Constructed from Unibox Modular Aluminium profiles and class one fire rated, beech laminated MDF panels. Alternative finishes available on request.

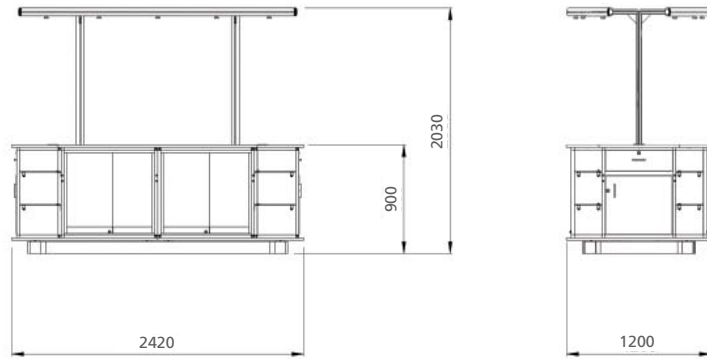

//halo merchandising unit

Cutting edge design, high quality, attention to detail, versatility, efficiency in production, all are synonymous with the Halo unit and all Unibox products.

The Halo RMU offers the perfect quality retail display solution to independent and multiple traders alike. You can specify the Halo unit to suit your individual display requirements.

Features & benefits:

- Halo lighting canopy featuring 10 spot lights
- Secure storage
- Lockable castors for ease of movement
- Fire rated, durable materials
- Cable management for till point including 2 x double switch socket and RCD fitted as standard
- Extensive range of accessories
- Drawer & cupboard to both ends
- Hooks for nightshirts pre-fitted

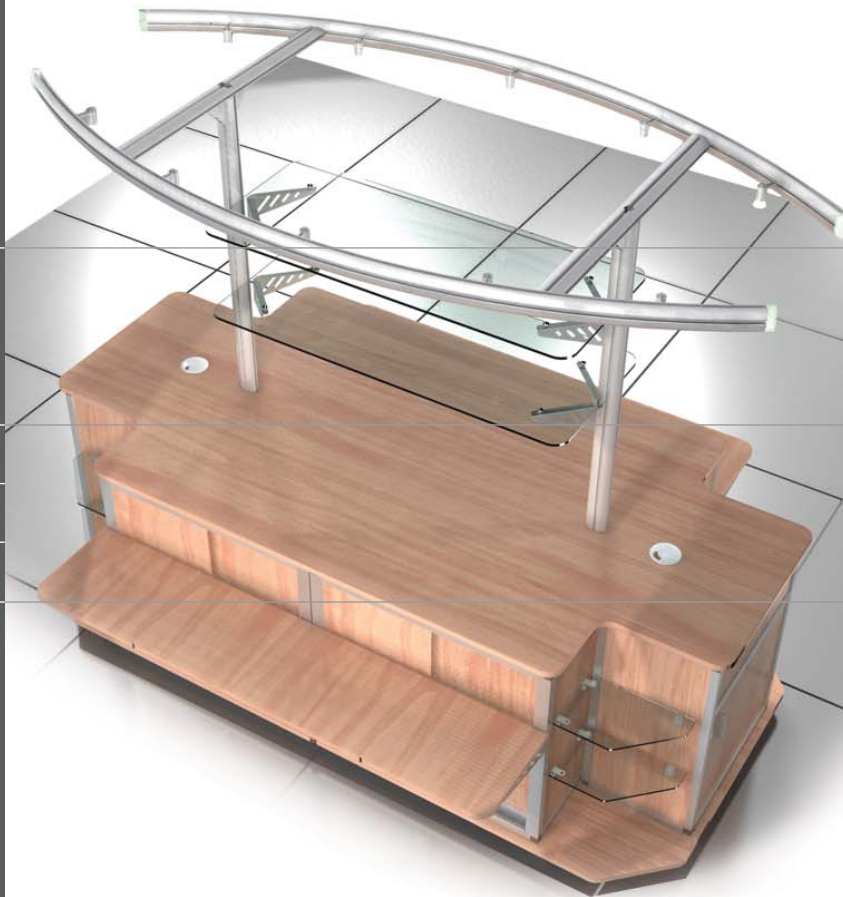

retail merchandising unit

cutting edge design

attention to detail

versatility

halo merchandising unit

For more information or to arrange for our RMU specialist to visit, please contact us today on 0161 277 6020 // email: sales@unibox.co.uk

//curved halo merchandising unit

Retail can be an erratic and unpredictable world, where the status quo changes almost daily. Yet there are some things which remain true and steadfast - like the Curved Halo Merchandising Unit.

Features & benefits:

- Halo lighting canopy featuring 10 spot lights
- Secure storage
- Lockable castors for ease of movement
- Fire rated, durable materials
- Optional backlit staging
- Cable management for till point including 2 x double switch socket and RCD fitted as standard
- Extensive range of accessories
- Drawer & cupboard to till end
- Curved shelving and storage to display end
- Optional curved feature roof available

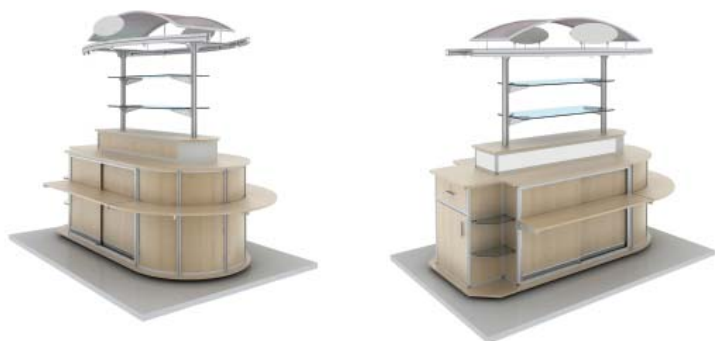

Our factory built units are designed to generate maximum sales in environments with heavy footfall. They present the opportunity to create additional retail floor space.

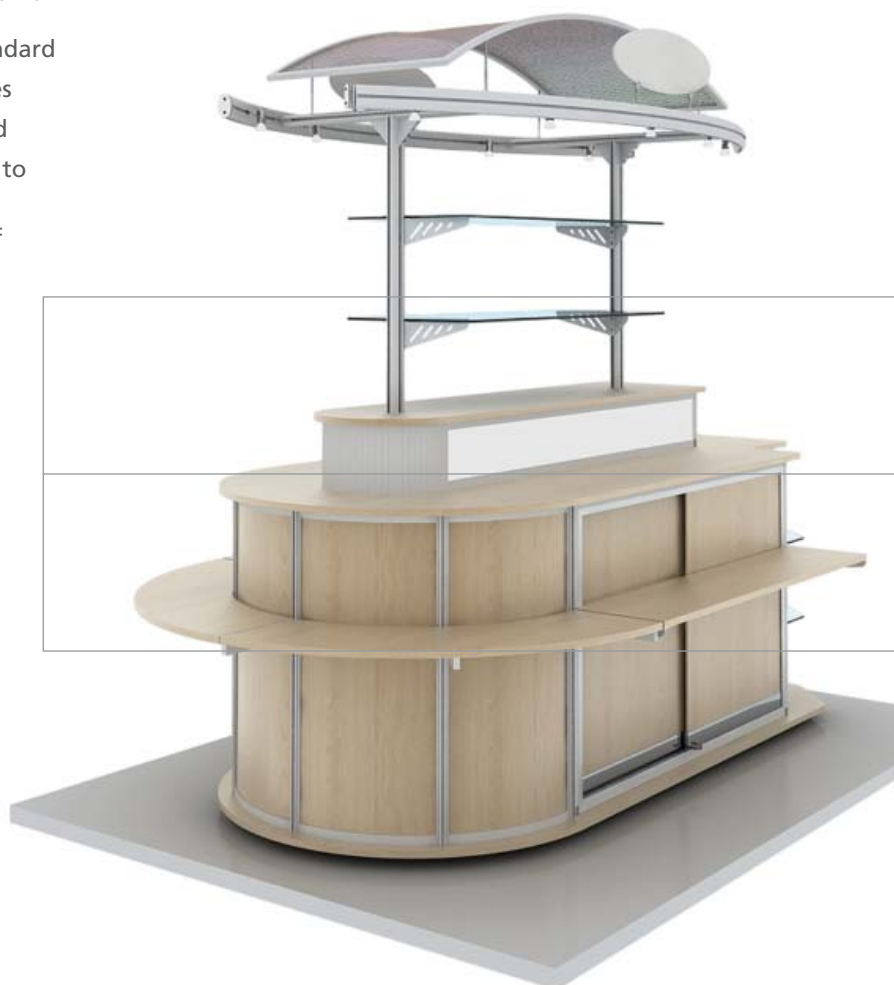
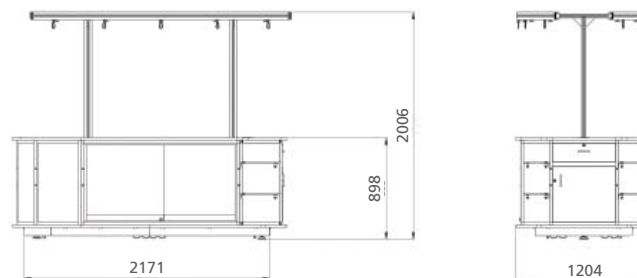

curved halo unit

curved halo unit

curved halo unit

curved halo unit

curved halo unit

curved halo unit

curved halo unit

curved halo unit

curved halo unit

curved halo unit

curved halo unit

curved halo unit

curved halo unit

The secure RMU suits traders who vacate the Centre prior to it closing for the day. Merchandise can be kept secure within the central display area.

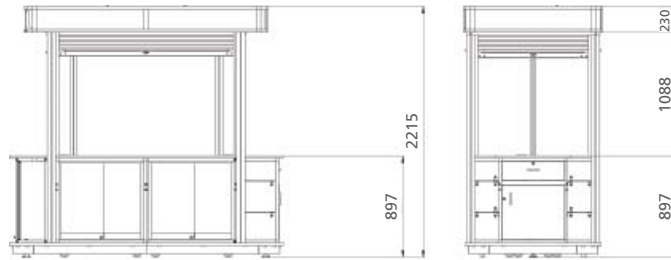

//secure merchandising unit

Ideal for Centres and retailers that require extra security. This unit is supplied with security shutters to fully enclose the main display area.

Features & benefits:

- Internal lighting in ceiling
- Secure storage
- Lockable castors for ease of movement
- Available with shutters or lockable glass sliding doors for added security
- Fire rated, durable materials
- Cable management for till point including 2 x double switch socket and RCD fitted as standard
- Extensive range of accessories
- Drawer & cupboard to front
- Optional folding shelves available



retail merchandising unit

secure unit

secure unit

For more information or to arrange for our RMU specialist to visit, please contact us today on 0161 277 6020 // email: sales@unibox.co.uk

//accessories

For added versatility, a glass showcase or aluminium slatwall panel can be retrofitted to the basic Halo unit. This provides maximum flexibility to suit individual traders' display requirements. Lockable castors are also fitted as standard, thereby creating a fully mobile display.

Start with a base unit, illustrated on page 4, then build up by adding any or all of the following:

- //1. Central, eye level, toughened glass display shelves
- //2. Central staging
- //3. Side cantilever shelving (optional folding shelves)
- //4. End cantilever shelving (optional folding shelves)
- //5. Signage

Adding all of the above to the generic base unit results in an RMU as illustrated.

For more options and relevant prices please refer to the technical specification and price list at the back of this catalogue.



HL006

Slatwall Panel

Double sided aluminium slatwall panel

Size: 1220mm x 1080mm

Suitable for both the Halo and Secure RMU ranges



HL008

Secure Glass Showcase

2 adjustable glass shelves
internal lighting available

Size: 1200mm x 400 x 1000mm

Suitable for both the Halo and Secure RMU ranges



HL009

Night Sheet - Royal Blue

Nylon cover sheet supplied as standard with every Halo/Curved unit

Alternative colours and additional sheets available on request

Suitable for the Halo RMU range only

//counter showcases

//created to complement any layout

Combining the various standard counters and showcases from the Unibox range gives retailers and designers the option of creating island displays or full store interiors, for maximum merchandising effect.

Unibox designs can also make the best use of previously redundant space under stairs or escalators, producing kiosks that deliver further retail opportunities.

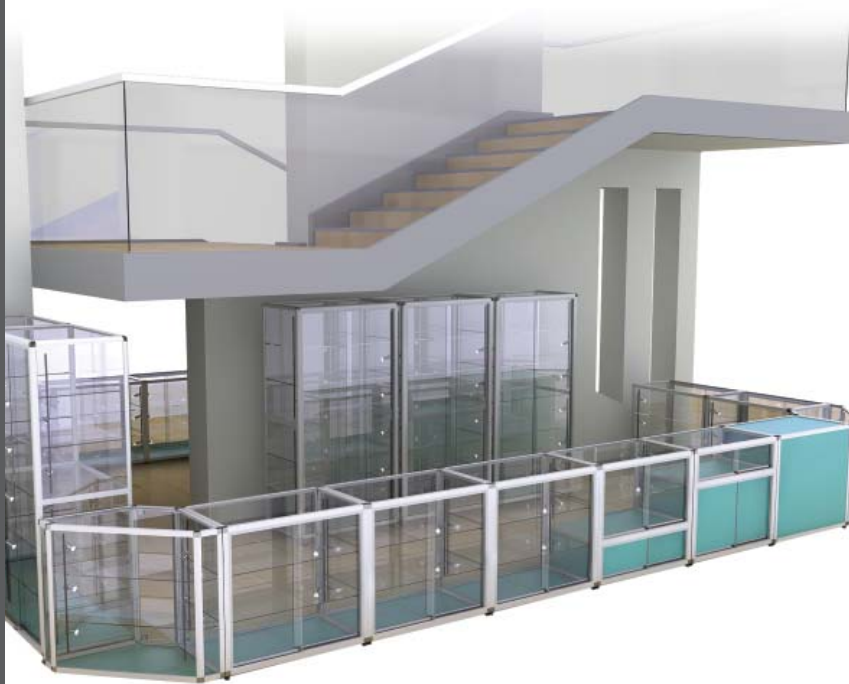

//1. Till Points

Designed to accommodate PC storage, cable management, cash desks and monitors.



//2. Counters

Available in various dimensions with combinations of display and storage to suit most requirements.

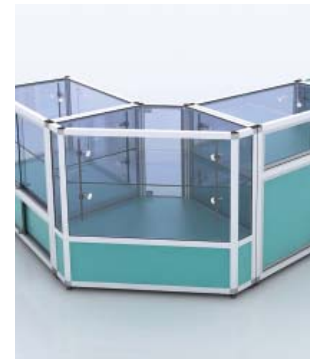

//3. Corner Units

Designed to be combined with counters for island displays.

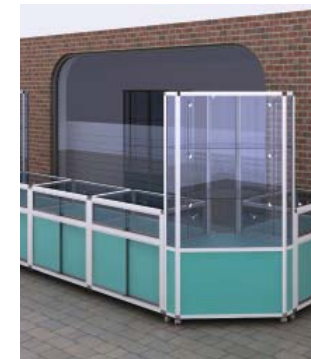

//4. Corner Towers

Combined with counters, corner towers offer maximum merchandising potential.



//5. Counter Tops

These cabinets offer POP merchandising potential and can be branded and co-ordinated with counter configurations.

//metro counter kits

At United Aluminium we understand that every retail and shopping mall environment is unique. We created the range of Metro counter kits for the mall, event and retail environments to allow you to create your own portable or static configurations.

The range consists of 9 individual kits, each designed and manufactured to the highest standards using our durable and sustainable aluminium system. To give more flexibility and the opportunity to configure the kits to complement your environment, each kit has options on assembly status, infill panels, counter tops and feature accessories.

Whether you are a designer, retailer, stand builder or shopfitter, this versatile counter kit range offers a stylish solution with attention to detail that is second to none.



Introducing the range of Metro counter kits, designed to enhance your retail or exhibition environment and display your products in style.

metro counter kits

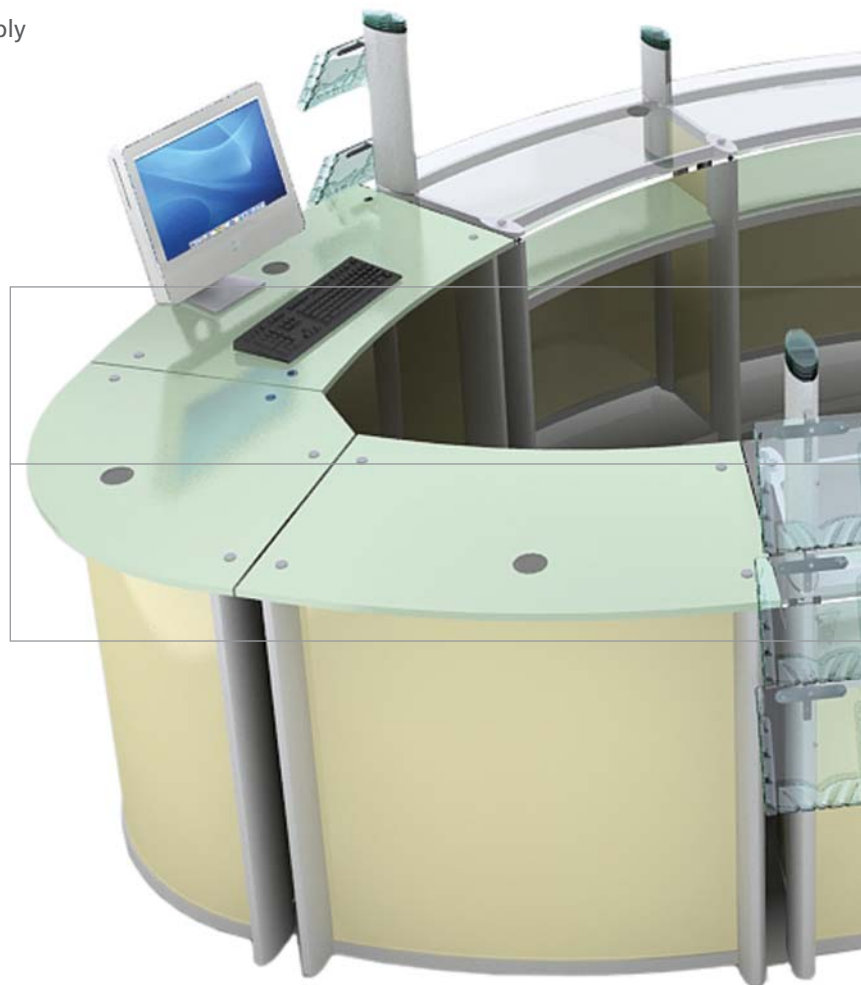
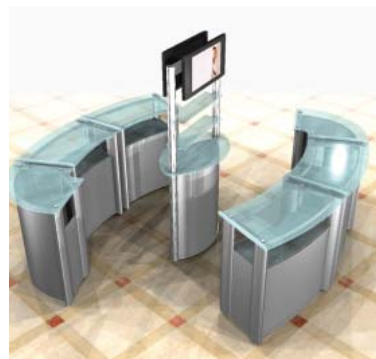

metro counter kits

Our 'off-the-shelf' kits allow for fast turnaround and delivery times, whilst maintaining a high quality designer solution. All kits are fully portable and are designed for ease of assembly and breakdown and come with step-by-step guide to assembly.

www.unibox.co.uk

metro counter kits

Mobile retail display units. The most cost-effective system yet, available for rental or outright purchase. Perfect for short-term lettings.



Constructed from the Unibox Modular Aluminium system and white laminate panelling. Endless configurations in modules of 1 metre long units make this the most versatile of counter displays.

Unibox mobile retail display units offer perfect cost-effective, start-up retail display solutions to independent and multiple traders alike.

//mobile retail display units

Configured using an assortment of standard counter display and storage units complemented with an array of accessories, including slat wall panels and lighting.

retail merchandising unit

8 configurations



mobile retail display units

This unit is the ideal 'gauge' for traders to establish if their chosen Centre is the place for them to be, before committing to a more permanent RMU or contract.

From a stand alone unit to an enclosed island module, this system has the versatility to achieve multiple configurations. All units are supplied on castors for ease of movement.

//endless possibilities

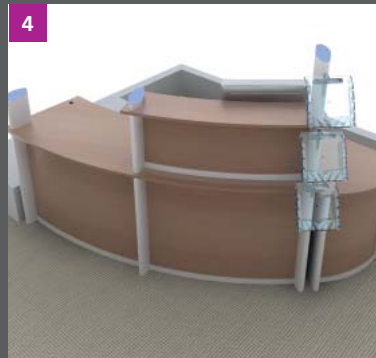

- //1. Tower showcase configuration
- //2. Bellá Pierre RMU
- //3. Customer service desk
- //4. Reception desk
- //5. Showcase kiosk configuration
- //6. Island Giftware RMU

- //7. Neocene modular showcase RMU
- //8. Box office kiosk
- //9. Food kiosk and counter configuration
- //10. External kiosk
- //11. Red Image RMU



retail merchandising unit

//retail merchandising unit

Holt Street
Manchester
M40 5AX
United Kingdom

t: +44 (0)161 277 6000
f: +44 (0)161 277 6030
e: sales@unitedaluminium.co.uk
w: www.unitedaluminium.co.uk

unibox[®]
A United Aluminium brand

available from: